

APPLICATION:

PRODUCT NAME: **DrainKing WASTE VALVE
ROUGH CHROME**

JOB NAME:

SPECIAL CONFIGURATION
CHECK BASE MODEL AND OPTIONS

QUANTITY:

ITEM NO.

MODEL:

29025 w/ LOCKING BASKET STRAINER &
OVERFLOW BODY

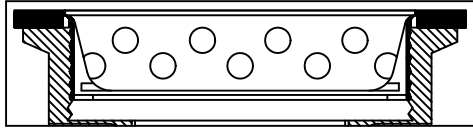

OPTIONS OR MODIFICATIONS:

- SUPPLY LINES (24" OR 36") CIRCLE LENGTH
- ADD-ON FAUCET (6", 8", 10", 12", 14", 16") CIRCLE
- IN-LINE DUAL CHECK VALVE
- HANDLES (CROSS OR WRIST) CIRCLE STYLE
- VANDAL RESISTANT KIT
- OTHER _____

FEATURES:

- * DUAL TEFLON SEALS
- * STAINLESS STEEL BALL
- * CAST RED BRASS BODY, CHROME PLATED
- * EXTRA STURDY STAINLESS STEEL CLAMPING RING
- * "CLEAR THROUGH " OPENING - NO NEED TO DISSASSEMBLE IF SNAKING IS REQUIRED
- * INDUSTRY STANDARD "SEALING" ANGLE - FITS FLUSH TO STANDARD STAINLESS STEEL SINKS
- * STAINLESS STEEL LOCKING BASKET STRAINER
- * 1/4 TURN FULLY OPENS AND CLOSES VALVE
- * END CAP W/ GASKET (INSTALLED)
- * SUPPLIED WITH:
ALTERNATE SLIP JOINT NUT & WASHER

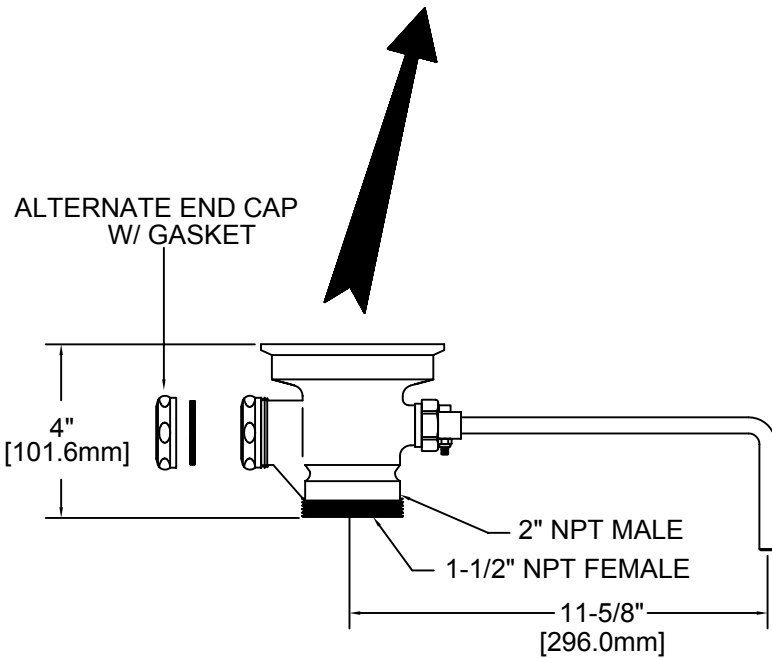

DRAIN RATE:

* 12 GPM

SHIPPING WEIGHT

* 5.5 LBS

ROUGH-IN:

DRAIN:

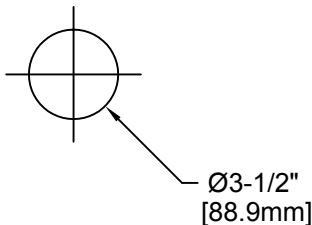

ANSI/A112.18.1M

FISHER

FISHER MANUFACTURING COMPANY

TOLL FREE: 800-421-6162 - FAX: 800-832-8238

information@fisher-mfg.com - www.fisher-mfg.com